

Ümartorud jatarvikud

Roostevabast- ja happekindlastterasesstorud

Keevitatud DIN 17457 lõõmutatud. DIN 2463 D3/T3

DN	du	s	kg/m
10	17,2	1,5	0,63
15	21,3	1,5	0,79
		2,0	0,96
20	26,9	1,5	1,01
		2,0	1,24
25	33,7	1,5	1,28
		2,0	1,58
32	42,4	1,5	1,63
		2,0	1,99
40	48,3	1,5	1,87
40	48,3	2,0	2,32
50	60,3	1,5	2,35
		2,0	2,92
65	76,1	1,5	2,99
		2,0	3,65
80	88,9	1,5	3,28
		2,0	4,35
100	114,3	1,5	4,24
		2,0	5,66
		2,5	7,04
100	114,3	3,0	8,36
125	139,7	2,0	6,90
		2,5	8,59
150	168,3	1,5	6,27
		2,0	8,33
		2,5	10,44
		3,0	12,40
200	219,1	2,0	10,90
		2,5	13,60
		3,0	16,30
250	273,0	2,0	13,60
		2,5	17,00
		3,0	20,30
300	323,9	2,5	20,19
		3,0	24,10
350	355,6	2,5	22,10
		3,0	26,50
400	406,4	3,0	30,40

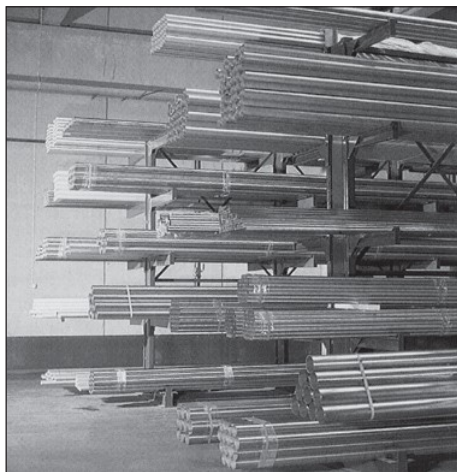

Keermestatavad torud

Keevitatud DIN 17457 lõõmutatud ja peitsitud. DIN 2463 D3T3

DN	du	s	kg/m
8	13,5	2,35	0,66
10	17,2	2,35	0,87
15	21,3	2,65	1,24
20	26,9	2,65	1,61
25	33,7	3,25	2,48
32	42,4	3,25	3,19
40	48,3	3,25	3,67
50	60,3	3,65	5,18
65	76,1	3,65	6,62
80	88,9	4,05	8,60
100	114,3	4,05	11,05

Roostevaba käsitoe toru, lihv ja poleer

DN	s	kg/m
25	1,5	0,883
25	2,0	1,152
38	1,5	1,371
40	1,5	1,446
50	1,5	1,721

Happekindlad kapillaartorud

Lõõmutatud D4/T3

du	s
2	0,5
3	0,5
3	1,0
4	0,5
4	1,0
5	0,5
5	1,0
6	0,5

Instrumenditorud

Keevitatud DIN 2463
lõõmutatud D4T3

du	s	kg/m
6	0,5	0,069
6	1,0	0,125
8	1,0	0,175
10	1,0	0,225
10	1,5	0,319
12	1,0	0,275
12	1,5	0,394
14	1,0	0,323
15	1,0	0,351
15	1,5	0,507
16	2,0	0,701
18	1,5	0,620
20	1,5	0,695
22	1,5	0,770
22	2,0	1,002
28	1,5	0,995
35	2,0	1,653
42	2,0	2,003

Roostevabad- ja happekindlad keevitatud põlved 90° AISI 304, AISI 316

DN	du	s	a	kg
10	17,2	2,0	28	0,04
15	20,0	2,0	30	0,04
	21,3	2,0	27	0,04
	21,3	2,6	27	0,06
20	25,0	2,0	27,5	0,05
	26,9	2,0	28,5	0,06
	26,9	2,6	28,5	0,08
	28,0	1,5	32,5	0,06
25	30,0	2,0	33,5	0,07
	33,7	2,0	38	0,10
	33,7	3,2	38	0,14
32	35,0	2,0	42	0,12
	42,4	2,0	47,5	0,16
	42,4	3,2	47,5	0,23
40	44,5	2,0	51	0,17
	48,3	2,0	57	0,22
	48,3	3,2	57	0,32
50	54,0	2,0	70	0,34
	60,3	2,0	76	0,34
	60,3	3,6	76	0,62

DN	du	s	a	kg
65	70,0	2,0	92	0,50
	76,1	2,0	95	0,62
	76,1	2,6	95	0,77
	76,1	3,6	95	1,08
80	84,0	2,0	105	0,75
	88,9	2,0	114,5	0,81
	88,9	2,5	114,5	1,02
	88,9	4,0	114,5	1,65
100	104,0	2,0	150	1,20
	114,3	2,0	152,5	1,30
	114,3	2,5	152,5	1,60
	114,3	3,0	152,5	2,00
	114,3	4,0	152,5	2,70
125	129,0	2,0	187,5	1,90
	139,7	2,0	190,5	2,10
	139,7	2,5	190,5	2,56
	139,7	3,0	190,5	3,08
150	154,0	2,0	225	2,75
	168,3	2,0	228,5	2,84
	168,3	2,5	228,5	3,75

DN	du	s	a	kg
150	168,3	3,0	228,5	4,90
200	204,0	2,0	300	4,75
	219,1	2,0	305	5,15
	219,1	2,5	305	6,20
	219,1	3,0	305	7,90
250	256,0	3,0	375	10,85
	273,0	3,0	381	12,00
300	306,0	3,0	450	16,10
	323,9	3,0	457	17,30
400	406,4	3,0	610	29,00

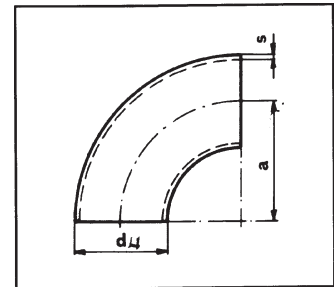

Pressitud kaelused DIN 2642 AISI 316 L

DN	du	D	r	s
10	17,2	40	3	3
15	21,3	45	3	3
20	26,9	58	3	3
25	33,7	68	4	3
32	42,4	78	4	3
40	48,3	88	4	3
50	56,0	102	4	3
50	60,3	102	4	3
65	76,1	122	5	3
80	86,0	138	5	3
80	88,9	138	5	3
80	88,9	138	5	4
100	108,0	158	5	4
100	114,3	158	5	3

DN	du	D	r	s
100	114,3	158	5	4
125	131,0	188	5	3
125	139,7	188	5	3
125	139,7	188	5	4
150	158,0	212	5	4
150	168,3	212	5	3
150	168,3	212	5	4
200	208,0	268	5	4
200	219,1	268	5	3
200	219,1	268	5	4
250	258,0	320	5	4
250	273,0	320	5	3
250	273,0	320	5	4
300	308,4	370	5	4

DN	du	D	r	s
300	323,9	370	5	3
300	323,9	370	5	4
350	358,0	430	5	4
400	408,0	480	5	4

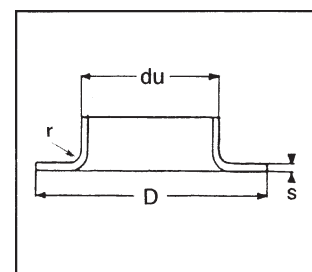

Keevitatud kaelused

SFS 4167 (PN 10) ja SFS 4168 (PN 16), SFS 4170 (PN 40)

DN	du	PN	D	h	s	L	kg
10	17,2	40	40	5	2,0	35	0,09
15	21,3	40	45	5	2,5	38	0,11
20	26,9	40	58	6	2,5	40	0,17
25	33,7	40	68	7	2,5	40	0,22
32	42,4	40	78	8	2,5	42	0,30
40	48,3	40	88	8	2,5	45	0,44
50	60,3	16	102	8	3,0	45	0,53
50	60,3	40	102	10	3,0	48	0,60
65	76,1	16	122	8	3,0	45	0,70
65	76,1	40	122	11	3,0	52	0,98
80	88,9	16	138	10	4,0	50	1,00
80	88,9	40	138	12	4,0	58	1,30
100	114,3	16	158	10	4,0	52	1,30
100	114,3	40	162	14	4,0	65	2,03
125	139,7	16	188	10	5,0	55	1,90
150	168,3	16	212	10	6,0	55	2,40
200	219,1	16	268	11	7,0	62	3,90
250	273,0	16	320	12	8,0	70	5,80
300	323,9	10	370	12	6,0	68	5,70
300	323,9	16	378	14	10	78	9,50

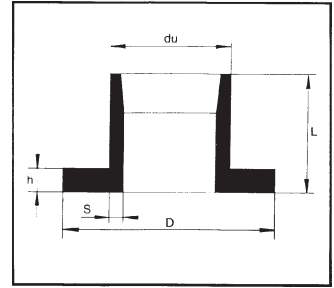

Happekindlad kolmikud AISI 316L

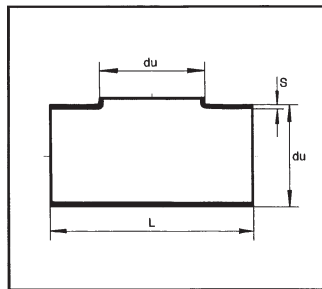

DN	du	s	L
10	17,2	2,0	120
15	21,3	2,0	120
20	26,9	2,0	120
25	33,7	2,0	160
32	42,4	2,0	180
40	48,3	2,0	200
50	60,3	2,0	230
65	76,1	2,0	280
80	88,9	2,0	300
100	114,3	2,0	320
125	139,7	2,0	360
150	168,3	2,5	400
200	219,1	2,5	400
250	273,0	3,0	500
300	323,9	3,0	600

Happekindlad toru lõpud AISI 316L

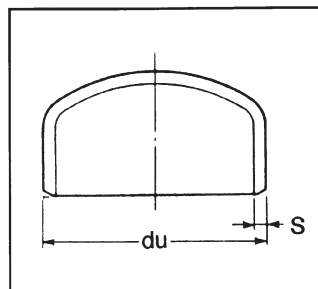

DN	du	s
15	21,3	2,0
20	26,9	2,0
25	33,7	3,0
32	42,4	3,0
40	48,3	3,0
50	60,3	3,0
65	76,1	3,0
80	88,9	3,0
100	114,3	3,0
125	139,7	3,0
150	168,3	3,0
200	219,1	3,0
250	273,0	3,0
300	323,9	3,0

Roostevabad torukandjad AISI 304

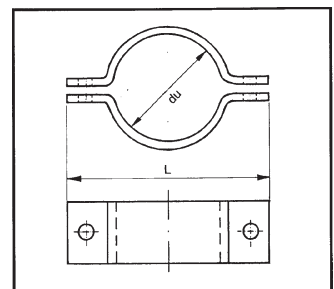

DN	du	L
10	17,2	68
15	21,3	72
20	26,9	80
25	33,7	88
32	42,4	98
40	48,3	102
50	60,3	125
65	76,1	145
80	88,9	158
100	114,3	178
125	139,7	215
150	168,3	238
200	219,1	265

Üleminekud

Happeakindlad AISI 316

D	D1	s
21,3	17,2	2
26,9	17,2	2
26,9	21,3	2
33,7	21,3	2
33,7	26,9	2
42,4	26,9	2
42,4	33,7	2
48,3	26,9	2
48,3	33,7	2
48,3	42,4	2
60,3	33,7	2
60,3	42,4	2
60,3	48,3	2
76,1	42,4	2
76,1	48,3	2
76,1	60,3	2
88,9	48,3	2
88,9	60,3	2
88,9	76,1	2
114,3	60,3	2
114,3	76,1	2
114,3	88,9	2
139,7	88,9	2

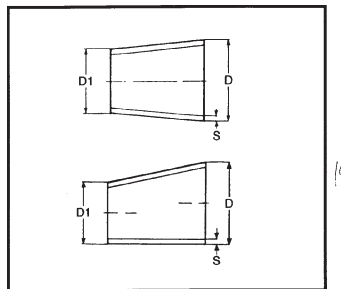

D	D1	s
139,7	114,3	2
168,3	88,9	2
168,3	114,3	2
168,3	139,7	2
219,1	139,7	2,5
219,1	168,3	2,5
273	168,3	2,5
273	219,1	2,5
323,9	219,1	2,5
323,9	273	2,5
355,6	219,1	3
355,6	273	3

Tsingitud ja silumiin
vabaäärükud

DN
10
15
20
25
32
40
50
65
80
100
125
150
200
250
300
400

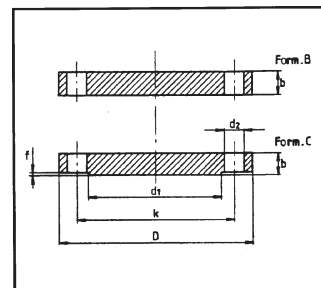

Pimeäärükud PN 10 DIN 2527 AISI 316

DN	Äärük					Poldid			Kaal kg
	D	k	d1	b	f	tk	Keere	d2	
10	90	60	40	14	2	4	M12	14	0,63
15	95	65	45	14	2	4	M12	14	0,72
20	105	75	58	16	2	4	M12	14	1,01
25	115	85	68	16	2	4	M12	14	1,23
32	140	100	78	16	2	4	M16	18	1,8
40	150	110	88	16	3	4	M16	18	2,09
50	165	125	102	18	3	4	M16	18	2,88
65	185	145	122	18	3	4	M16	18	3,7
80	200	160	138	20	3	8	M16	18	4,83
100	220	180	158	20	3	8	M16	18	5,75
125	250	210	188	33	3	8	M16	18	8,59
150	285	240	212	22	3	8	M20	22	10,6
200	340	295	268	24	3	8	M20	22	15,6
250	395	350	320	26	3	12	M20	22	23,1
300	445	400	370	26	4	12	M20	22	29,4
350	505	460	430	26	4	16	M20	22	38,0
400	565	515	482	26	4	16	M24	26	47,5
500	670	620	585	28	4	20	M24	26	72,7

Keevitatud kaelusäärik PN 16 DIN 2633 AISI 316

DN	du	Äärik										Poldid			Kaal kg
		D	b	k	h1	d3	s	r	h2	d4	f	tk	Keere	d2	
10	17,2	90	14	60	35	28	1,8	4	6	40	2	4	M12	14	0,58
15	21,3	95	14	65	35	32	2	4	6	45	2	4	M12	14	0,65
20	26,9	105	16	75	38	40	2,3	4	6	58	2	4	M12	14	0,95
25	33,7	115	16	85	38	45	2,6	4	6	68	2	4	M12	14	1,14
32	42,4	140	16	100	40	56	2,6	6	6	78	2	4	M16	18	1,69
40	48,3	150	16	110	42	64	2,6	6	7	88	3	4	M16	18	1,86
50	60,3	165	18	125	45	75	2,9	6	8	102	3	4	M16	18	2,53
65	76,1	185	18	145	45	90	2,9	6	10	122	3	4	M16	18	3,06
80	88,9	200	20	160	50	105	3,2	8	10	138	3	8	M16	18	3,7
100	114,3	220	20	180	52	131	3,6	8	12	158	3	8	M16	18	4,62
125	139,7	250	22	210	55	156	4	8	12	188	3	8	M16	18	6,3
150	168,3	285	22	240	55	184	4,5	10	12	212	3	8	M20	22	7,75
200	219,1	340	24	295	62	235	5,9	10	16	268	3	12	M20	22	11,0
250	273	405	26	355	70	292	6,3	12	16	320	3	12	M24	26	15,6
300	323,9	460	28	410	78	344	7,1	12	16	378	4	12	M24	26	22,0
350	355,6	520	30	470	82	390	8	12	16	438	4	16	M24	26	31,2
400	406,4	580	32	525	85	445	8	12	16	490	4	16	M27	30	39,3
500	508	715	34	650	90	548	8	12	16	610	4	20	M30	33	61,0
600	609,6	840	36	770	95	652	8,8	12	18	725	5	20	M33	36	75,4

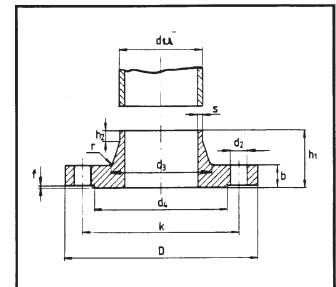
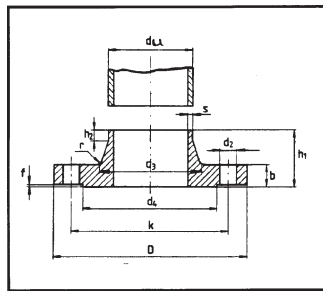

Keevitatud kaelusäärik PN 40 DIN 2635 AISI 316

DN	du	Äärik										Poldid			Kaal kg
		D	b	k	h1	d3	s	r	h2	d4	f	tk	Keere	d2	
10	17,2	90	16	60	35	28	1,8	4	6	40	2	4	M12	14	0,66
15	21,3	95	16	65	38	32	2	4	6	45	2	4	M12	14	0,75
20	26,9	105	18	75	40	40	2,3	4	6	58	2	4	M12	14	1,06
25	33,7	115	18	85	40	46	2,6	4	6	68	2	4	M12	14	1,29
32	42,4	140	18	100	42	56	2,6	6	6	78	2	4	M16	18	1,88
40	48,3	150	18	110	45	64	2,6	6	7	88	3	4	M16	18	2,33
50	60,3	165	20	125	48	75	2,9	6	8	102	3	4	M16	18	2,82
65	76,1	185	22	145	52	90	2,9	6	10	122	3	8	M16	18	3,74
80	88,9	200	24	160	58	105	3,2	8	12	138	3	8	M16	18	4,75
100	114,3	235	24	190	65	134	3,6	8	12	162	3	8	M20	22	6,52
125	139,7	270	26	220	68	162	4	8	12	188	3	8	M24	26	9,07
150	168,3	300	28	250	75	192	4,5	10	12	218	3	8	M24	26	11,8
200	219,1	375	34	320	88	244	6,3	10	16	285	3	12	M27	30	21,5
250	273	450	38	385	105	306	7,1	12	18	345	3	12	M30	33	34,9
300	323,9	515	42	450	115	362	8	12	18	410	4	16	M30	33	49,7
350	355,6	580	46	510	125	408	8,8	12	20	465	4	16	M33	36	68,1
400	406,4	660	50	585	135	462	11	12	20	535	4	16	M36	39	96,5
500	508	755	52	670	140	562	14,2	12	20	615	4	20	M39	42	117

Keevitatav äärik PN 10 DIN 2576 AISI 316L

DN	du	Äärik					Poldid			Kaal kg
		D	k	b	d1	e	tk	Keere	d2	
10	17,2	90	60	14	20	3	4	M12	14	0,57
15	21,3	95	65	14	24	3	4	M12	14	0,72
20	26,9	105	75	14	30	3	4	M12	14	0,8
25	33,7	115	85	16	37	4	4	M12	14	1,08
32	42,4	140	100	16	46	4	4	M16	18	1,6
40	48,3	150	110	16	52	4	4	M16	18	1,81
50	60,3	165	125	16	64	5	4	M16	18	2,16
65	76,1	185	145	16	81	5	4	M16	18	2,62
80	88,9	200	160	18	94	5	8	M16	18	3,32
100	114,3	220	180	18	119	5	8	M16	18	3,43
125	139,7	250	210	18	145	5	8	M16	18	4,32
150	168,3	285	240	18	174	5	8	M20	22	5,15
200	219,1	340	295	20	225	5	8	M20	22	7,4
250	273	395	350	22	279	5	12	M20	22	9,4
300	323,9	445	400	26	329	5	12	M20	22	13,5
350	355,6	505	460	28	362	6	16	M20	22	20,0
400	406,4	565	515	32	413	6	16	M24	26	27,4
500	508	670	620	38	517	6	20	M24	26	37,2
600	609,6	780	725	44	618	7	20	M27	30	56,5

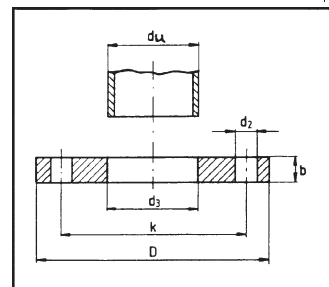
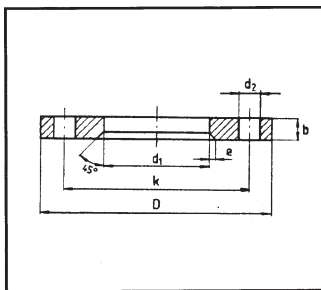

Vabaäärik PN 10 DIN 2642 AISI 316

DN	du	Äärik				Poldid			Kaal kg
		D	k	b	d3	tk	Keere	d2	
10	17,2	90	60	14	17,7	4	M12	14	0,6
15	21,3	95	65	14	21,8	4	M12	14	0,7
20	26,9	105	75	16	27,4	4	M12	14	0,9
25	33,7	115	85	16	34,2	4	M12	14	1,1
32	42,4	140	100	16	42,9	4	M16	18	1,8
40	48,3	150	110	16	48,8	4	M16	18	2,0
50	60,3	165	125	18	60,8	4	M16	18	2,5
65	76,1	185	145	18	76,6	4	M16	18	3,5
80	88,9	200	160	20	89,9	8	M16	18	4,0
100	114,3	220	180	20	115,3	8	M16	18	4,5
125	139,7	250	210	22	140,7	8	M16	18	6,0
150	168,3	285	240	22	169,3	8	M20	22	7,5
200	219,1	340	295	24	220,1	8	M20	22	10,0
250	273	395	350	26	274	12	M20	22	12,5
300	323,9	445	400	26	325,9	12	M20	22	14,5
350	355,6	505	460	28	357,6	16	M20	22	20,0
400	406,4	565	515	32	408,4	16	M24	26	25,0
500	508	670	620	38	510	20	M24	26	35,0

Äärikute võrdlustabel

	PN	6	10	16	25	40	64	100	160	250	320	400
Keevitatav kaelusäärik	DIN	2631	2632	2633	2634	2635	2636	2637	2638	2628	2629	2627
	SFS	2152	2153	2154	2155	2156	2157	2158	2159	2160	2161	2162
	SMS	2031	2032	2033	2034	2035	2036	2037				
Keevitatav äärik	DIN	2573	2576									
	SFS	2183	2184									
	SMS	2023	2024	2025								
Vabaäärik	DIN	2641	2642	2654	2655	2656			2645	2646	2647	
		2652	2653						2667	2668	2669	
		2673										
Vabaäärik	SFS	2169	2170	4171	4172	4173						
			2180									
	SMS		2049	2050	2051	2052						
Pimeäärik	DIN	2527	2527	2527	2527	2527	2527	2527				
	SFS	2166	2166	2166	2166	2166	2166	2166				

Standardite võrdlustabel

AISI	W NR	prEN 10088	Polarft	SS
329	4460	X3CRNIMON27-5-2		2324
301	4310	X9CRN118-8	710	2331
303	4305	X8CRNIS18-9		2346
304L	4306	X2CRN119-11	720	2352
403LN	4311	X2CRN118-10	721	2371
304	4301	X4CRN118-10	725	2333
321	4541	X6CRNIT118-10	731	2337
309S	4833		744	
316L	4404	X2CRN1M017-12-2	750	2348
316LN	4406	X2CRN1M017-11-2	751	
316L	4435	X2CRN1M018-14-3	752	2353
316LN	4429	X2CRNIMON17-13-3	753	2375
316	4401	X4CRN1M017-12-2	755	2347
316	4436	X4CRN1M017-13-3	757	2343
316TN	4571	X6CRN1M0T117-12-2	761	2350
317L	4438	X2CRN1M018-15-4	770	2367
	4439	X2CRNIMON17-13-5	772	
	4449		773	
NO8904	4539	X1NICRMOCU25-20-5	774	2562
S31254	4529	X1N1CRM000N25-20-7	778	

Happekindladkeermestatud toruliitmikud AISI 316 DIN 2999

Muhv

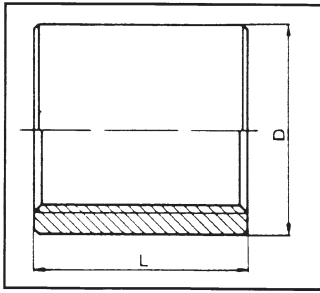

DN	R	L mm	D mm
6	1/8"	22	16
8	1/4"	25	19
10	3/8"	30	22
15	1/2"	35	28
20	3/4"	40	34
25	1"	45	40
32	1.1/4"	50	50
40	1.1/2"	55	56
50	2"	60	70
65	2.1/2"	70	88
80	3"		104
100	4"	85	132

Poolmuhv

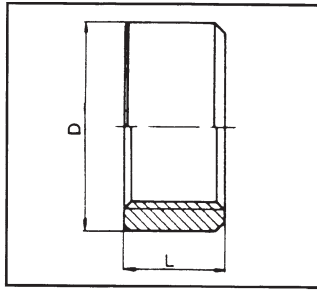

DN	R	L mm	D mm
6	1/8"	8	14
8	1/4"	11	18
10	3/8"	12	21
15	1/2"	15	26
20	3/4"	17	32
25	1"	20	39
32	1.1/4"	22	48
40	1.1/2"	22	55
50	2"	26	68

Nurkühendus S/S

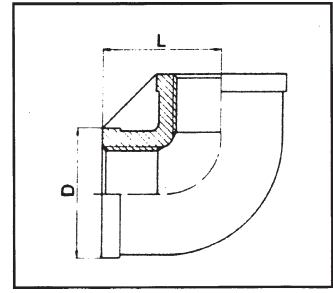

DN	R	L mm
6	1/8"	18
8	1/4"	21
10	3/8"	24
15	1/2"	28
20	3/4"	33
25	1"	38
32	1.1/4"	43
40	1.1/2"	49
50	2"	57
65	2.1/2"	69
80	3"	78

Nurkühendus S/U

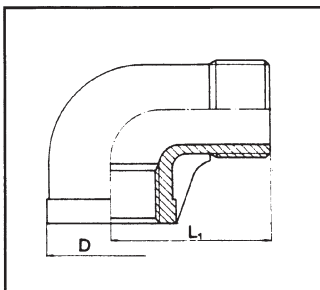

DN	R	L mm
8	1/4"	30
10	3/8"	35
15	1/2"	41
20	3/4"	48
25	1"	54
32	1.1/4"	62
40	1.1/2"	68
50	2"	83

Kolmikühendus

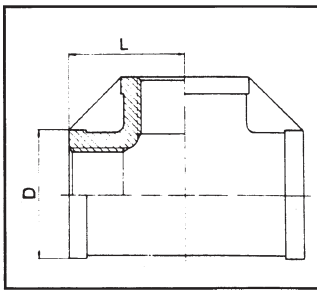

DN	R	L mm
6	1/8"	18
8	1/4"	21
10	3/8"	24
15	1/2"	28
20	3/4"	33
25	1"	38
32	1.1/4"	43
40	1.1/2"	49
50	2"	57
65	2.1/2"	69
80	3"	78

(Koonus) K-liide S/S

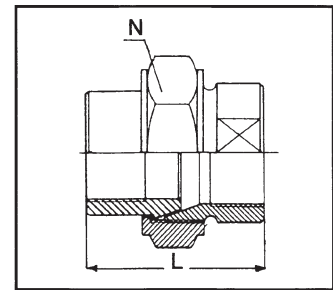

DN	R	L mm	N
6	1/8"	37	19
8	1/4"	45	27
10	3/8"	45	32
15	1/2"	45	36
20	3/4"	52	46
25	1"	57	50
32	1.1/4"	66	60
40	1.1/2"	69	65
50	2"	76	83
65	2.1/2"	89	100
80	3"	102	115

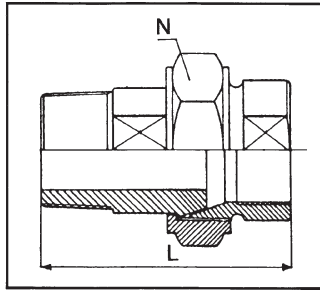
(Koonus)K-liide S/U

DN	R	L mm	N
6	1/8"	48	19
8	1/4"	56	27
10	3/8"	58	32
15	1/2"	60	36
20	3/4"	68	46
25	1"	75	50
32	1.1/4"	86	60
40	1.1/2"	91	65
50	2"	110	83
65	2.1/2"	115	100
80	3"	130	115

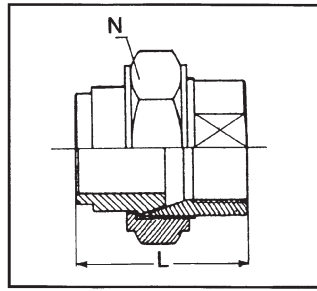
(Koonus) K-liidekeevitatav

DN	du	L mm	N
6	10,2	32	19
8	13,5	32	27
10	17,2	40	32
15	21,3	40	36
20	26,9	44	46
25	33,7	53	50
32	42,4	57	60
40	48,3	63	65
50	60,3	74	83

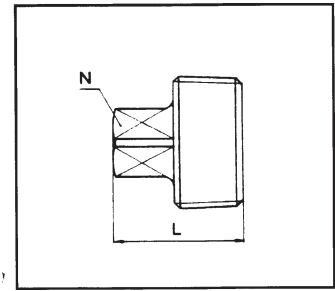
Nelikant koonuskork

DN	R	L mm	N mm
6	1/8"	16	7
8	1/4"	18	9
10	3/8"	21	12
15	1/2"	25	14
20	3/4"	30	17
25	1"	35	19
32	1.1/4"	35	23
40	1.1/2"	36	26
50	2"	41	32
65	2.1/2"	48	41
80	3"	53	46

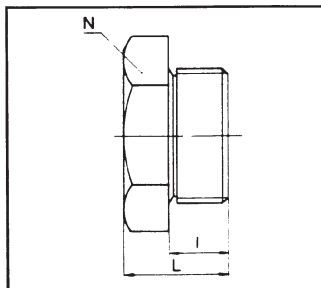
Kuuskant silinderkork

DN	R	L mm	N mm	1 mm
6	1/8"	12	17	7
8	1/4"	15	19	9
10	3/8"	16	22	9
15	1/2"	18	27	12
20	3/4"	22	29	13
25	1"	26	41	15
32	1.1/4"	30	50	19
40	1.1/2"	32	55	20
50	2"	36	70	24

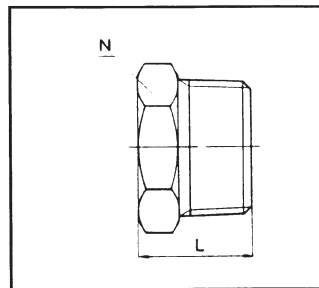
Kuuskant koonuskork

DN	R	L mm	N
6	1/8"	21	14
8	1/4"	23	17
10	3/8"	26	19
15	VT	27	24
20	3/4"	34	29
25	1"	35	40
32	1.1/4"	40	51
40	1.1/2"	42	53
50	2"	46	66
65	2.1/2"	54	80
80	3"	60	95

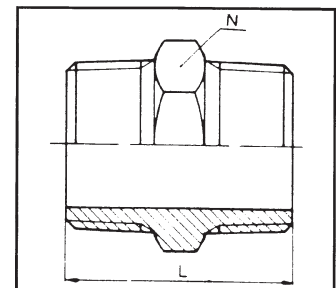
Kaksiknippel

DN	R	L mm	N
6	1/8"	32	14
8	1/4"	34	17
10	3/8"	36	21
15	1/2"	42	26
20	3/4"	47	32
25	1"	52	38
32	1.1/4"	56	46
40	1.1/2"	60	54
50	2"	66	63
65	2.1/2"	73	80
80	3"	81	95
100	4"	92	120

Keevitatavkaksinippel

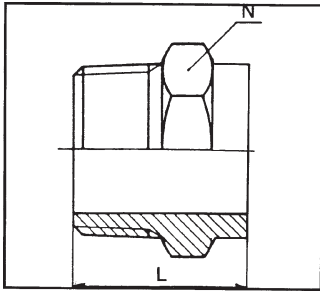

DN	R	L mm	N mm
6	1/8"	29	14
8	1/4"	29	17
10	3/8"	29	21
15	1/2"	32	26
20	3/4"	36	32
25	1"	40	38
32	1.1/4"	44	46
40	1.1/2"	44	54
50	2"	49	63
65	2.1/2"	55	80
80	3"	63	95

Torunippel

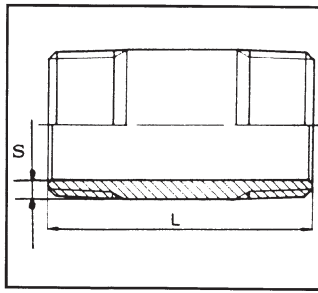

DN	R	L mm	D mm	S mm
6	1/8"	30	10	2,0
8	1/4"	30	13	2,3
10	3/8"	40	17	2,3
15	1/2"	60	21	2,6
20	3/4"	60	26	2,6
25	1"	60	33	3,2
32	1.1/4"	80	42	3,2
40	1.1/2"	80	48	3,2
50	2"	100	60	3,6
65	2.1/2"	100	76	3,6
80	3"	120	88	4,0
100	4"	150	114	4,0

Keevitatav nippel

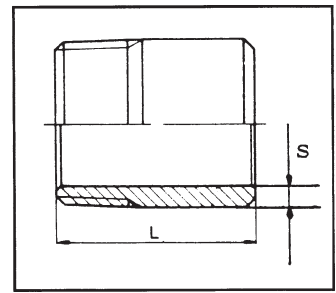

DN	R	L mm	D mm	S mm
6	1/8"	30	10	2,0
8	1/4"	30	13	2,3
10	3/8"	30	17	2,3
15	1/2"	35	21	2,6
20	3/4"	40	26	2,6
25	1"	40	33	3,2
32	1.1/4"	50	42	3,2
40	1.1/2"	50	48	3,2
50	2"	50	60	3,6
65	2.1/2"	60	76	3,6
80	3"	70	88	4,0
100	4"	80	114	4,5

Torukaar 90°

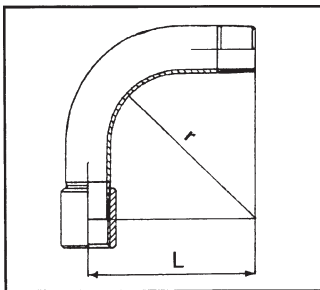

DN	R	L mm	r mm
6	1/8"	50	30
8	1/4"	60	40
10	3/8"	70	45
15	1/2"	80	55
20	3/4"	100	70
25	1"	120	80
32	1.1/4"	140	95
40	1.1/2"	180	115
50	2"	190	125

Kuuskantkübar

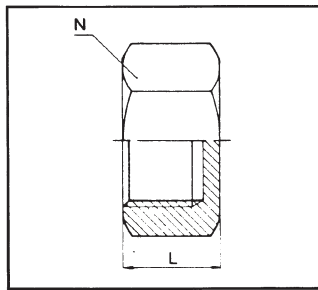

DN	R	L mm	N mm
6	1/8"	13	15
8	1/4"	15	17
10	3/8"	17	21
15	1/2"	19	27
20	3/4"	22	30
25	1"	24	38
32	1.1/4"	27	55
40	1.1/2"	27	59
50	2"	36	68
65	2.1/2"	40	85
80	3"	45	90

Lukustusmutter

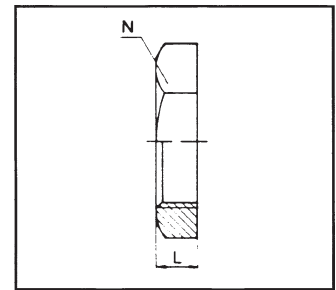

DN	R	L mm	N mm
6	1/8"	7	17
8	1/4"	8	21
10	3/8"	9	26
15	1/2"	9	32
20	3/4"	10	38
25	1"	11	46
32	1.1/4"	12	54
40	1.1/2"	13	63
50	2"	15	77
65	2.1/2"	17	100
80	3"	18	115

Üleminekunippel

DN	R	L mm	N
8 x 6	1/4" x 1/8"	17	17
10 x 6	3/8" x 1/8"	18	21
10 x 8	3/8" x 1/4"	18	21
15 x 6	1/2" x 1/8"	21	26
15 x 8	1/2" x 1/4"	21	26
15 x 10	1/2" x 3/8"	21	26
20 x 8	3/4" x 1/4"	24	32
20 x 10	3/4" x 3/8"	24	32
20 x 15	3/4" x 1/2"	24	32
25 x 8	1" x 1/4"	27	38
25 x 10	1" x 3/8"	27	38
25 x 15	1" x 1/2"	27	38
25 x 20	1" x 3/4"	27	38
32 x 15	1.1/4" x 1/2"	30	46
32 x 20	1.1/4" x 3/4"	30	46
32 x 25	1.1/4" x 1"	30	46
40 x 15	1.1/2" x 1/2"	32	54
40 x 20	1.1/2" x 3/4"	32	54
40 x 25	1.1/2" x 1"	32	54
40 x 32	1.1/2" x 1.1/4"	32	54
50 x 25	2" x 1"	36	63
50 x 32	2" x 1.1/4"	36	63
50 x 40	2" x 1.1/2"	36	63
65 x 40	2.1/2" x 1.1/2"	39	80
65 x 50	2.1/2" x 2"	39	80
80 x 50	3" x 2"	44	95
80 x 65	3" x 2.1/2"	44	95

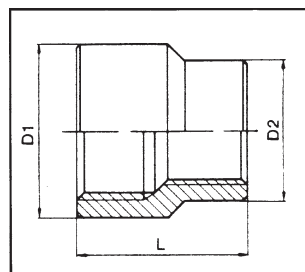
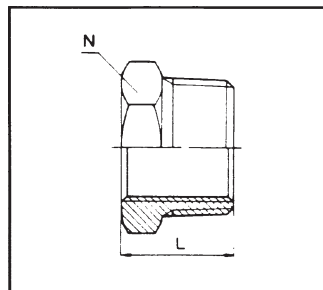

Ülemineku kaksiknippel

DN	R	L mm	N
8 x 6	1/4" x 1/8"	34	14
10 x 8	3/8" x 1/4"	35	17
15 x 8	1/2" x 1/4"	38	22
15 x 10	1/2" x 3/8"	38	22
20 x 10	3/4" x 3/8"	42	29
20 x 15	3/4" x 1/2"	42	29
25 x 15	1" x 1/2"	50	36
25 x 20	1" x 3/4"	50	36
32 x 25	1.1/4" x 1"	54	46
40 x 25	1.1/2" x 1"	59	55
40 x 32	1.1/2" x 1.1/4"	59	55
50 x 25	2" x 1"	64	63
50 x 32	2" x 1.1/4"	64	63
50 x 40	2" x 1.1/2"	64	63
65 x 50	2.1/2" x 2"	73	80
80 x 50	3" x 2"	81	95
80 x 65	3" x 2.1/2"	81	95

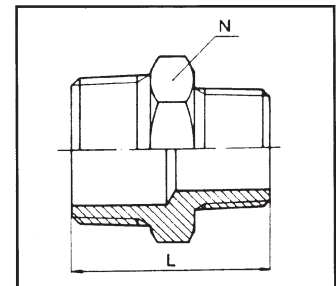

Üleminekumuuhv

DN	R	L mm	Di	D2
8 x 6	1/4" x 1/8"	25	21	16
10 x 6	3/8" x 1/8"	28	26	16
10 x 8	3/8" x 1/4"	28	26	21
15 x 8	1/2" x 1/4"	34	30	21
15 x 10	1/2" x 3/8"	34	30	26
20 x 10	3/4" x 3/8"	38	37	26
20 x 15	3/4" x 1/2"	38	37	30
25 x 15	1" x 1/2"	42	45	30
25 x 20	1" x 3/4"	42	45	37
32 x 20	1.1/4" x 3/4"	48	55	37
32 x 25	1.1/4" x 1"	48	55	45
40 x 25	1.1/2" x 1"	52	62	45
40 x 32	1.1/2" x 1.1/4"	52	62	55
50 x 25	2" x 1"	58	75	45
50 x 32	2" x 1.1/4"	58	75	55
50 x 40	2" x 1.1/2"	58	75	62
65 x 50	2.1/2" x 2"	65	91	75
80 x 50	3" x 2"	72	110	75
80 x 65	3" x 2.1/2"	72	110	91

Voolikuots

DN	R	L mm	N	D1 mm
6	1/8"	50	14	6,5
8	1/4"	50	14	6,5
8	1/4"	50	14	8
8	1/4"	50	14	10
10	3/8"	56	19	10
10	3/8"	56	19	13
10	3/8"	56	19	16
15	1/2"	66	22	10
15	1/2"	66	22	13
15	1/2"	66	22	16
15	1/2"	66	22	19
20	3/4"	75	29	20
20	3/4"	75	29	25
25	1"	84	36	25
32	1.1/4"	97	46	32
40	1.1/2"	103	55	40
50	2"	116	65	50
65	2.1/2"	138	80	65
80	3"	151	95	80

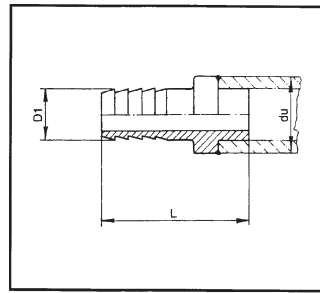
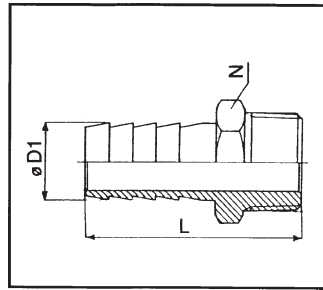

Keevitatavvoolikuots

DN	du	L	D1
6	10,2	40	6,5
8	13,5	40	9
10	17,2	52	14
15	21,3	52	14
15	21,3	52	21
20	26,9	52	21
20	26,9	65	26
25	33,7	65	26
25	33,7	65	33
32	42,4	65	33
40	48,3	75	41
50	60,3	75	51
65	76,1	88	64
80	88,9	88	76

Surveliitmikud DIN 2353 1,4571

Lõppliide

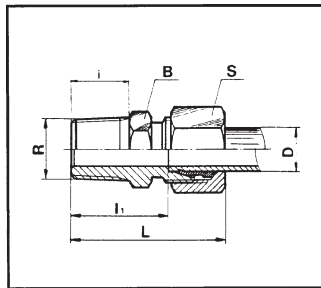

D	R	S	B	L	11
6	R 1/8"	14	12	30,5	16
6	R 1/4"	14	12	34,5	20
8	R 1/4"	17	14	35	20
8	R 3/8"	17	14	35	20
10	R 1/4"	19	17	36	21
10	R 3/8"	19	17	36	21
10	R 1/2"	19	17	36	21
12	R 1/4"	22	19	37	22
12	R 3/8"	22	19	37	22
12	R 1/2"	22	22	39	24
15	R 3/8"	27	24	40	25
15	R 1/2"	27	24	40	25
18	R 1/2"	32	27	42	25,5
18	R 3/4"	32	27	42	25,5
22	R 1/2"	36	32	46	29,5
22	R 3/4"	36	32	46	29,5

Jätuliide

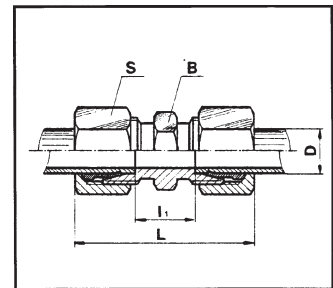

D	S	B	L	11
6	14	12	39	10
8	17	14	40	11
10	19	17	42	13
12	22	19	43	14
15	27	24	46	16
18	32	27	48	16
22	36	32	52	20
28	41	41	54	21

Nurklõppliide

D	R	S	B	L	11	A
6	R 1/8"	14	12	26,5	12,0	20
6	R 1/4"	14	12	26,5	12,0	24
8	R 1/8"	17	12	28,5	14,0	24
8	R 1/4"	17	12	28,5	14,0	26
8	R 3/8"	17	14	29,5	15,0	27
10	R 1/4"	19	14	29,5	15,0	27
10	R 3/8"	19	14	29,5	15,0	28
10	R 1/2"	19	19	29,5	15,0	31
12	R 1/4"	22	17	32,0	17,0	28
12	R 3/8"	22	17	32,0	17,0	28
12	R 1/2"	22	19	36,0	21,0	32
15	R 3/8"	27	19	36,0	21,0	34
15	R 1/2"	27	19	36,0	21,0	32
18	R 1/2"	32	24	40,0	23,5	36
18	R 3/4"	32	24	40,0	23,5	36
22	R 1/2"	36	27	44,0	27,5	42
22	R 3/4"	36	27	44,0	27,5	42

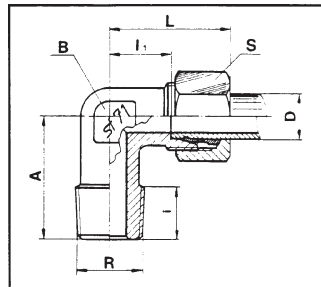

Nurkliide

D	S	B	L	11
6	14	12	27	12
8	17	12	29	12
10	19	14	30	15
12	22	17	32	17
15	27	19	36	21
18	32	24	40	23,5
22	36	27	44	27,5
28	41	36	47	30,5

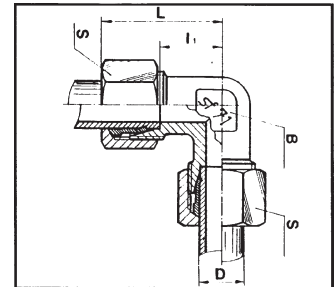

Kolmikliide

D	S	B	L	11
6	14	12	27	12
8	17	12	29	14
10	19	14	30	15
12	22	17	32	17
15	27	19	36	21
18	32	24	40	23,5
22	36	27	44	27,5
28	41	36	47	30,5

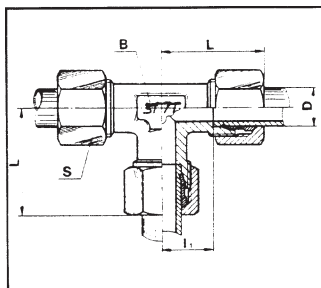

Mutter

D	M	H	S
6	M 12x1,5	14,5	14
8	M 14x1,5	14,5	17
10	M 16x1,5	15,5	19
12	M 18x1,5	15,5	22
15	M 22x1,5	17	27
18	M 26x1,5	18	32
22	M 30x2	20	36
28	M 36x2	21	41

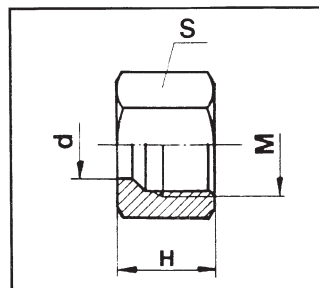

Lõikerõngas

D	L
6	9,5
8	9,5
10	10
12	10
15	10
18	10
22	10,5
28	10,5

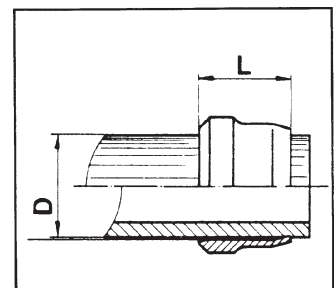

Happekindlad kuulkraanid

Poolauk AISI 316 S/S (sise/sise)

Suurus	d	L	H	W
1/4"	5	40	33	67
3/8"	7	45	36	67
1/2"	9	58	42	90
3/4"	12,5	60	45	90
1"	16	72	52	112
1-1/4"	20	80	57	112
1-1/2"	24,5	85	60	132
2"	32	102	66	132

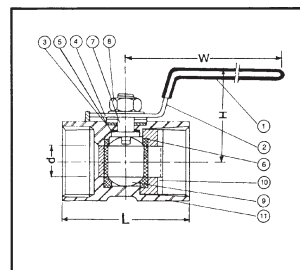

Täisauk 2-osaline AISI 316 S/S (sise/sise)

Suurus	d	L	H	W
1/4"	11,6	52	48	120
3/8"	12,7	52	48	120
1/2"	15	66	49	120
3/4"	20	70	55	130
1"	25,4	83	69	155
1-1/4"	32	97	77	155
1-1/2"	38	108	84	185
2"	50,8	135	93	185
2-1/2"	65	158	138	250
3"	80	185	149	250

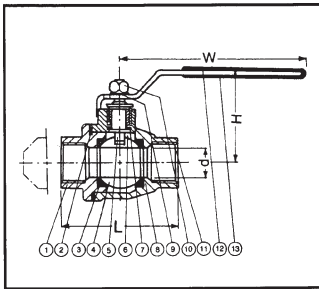

Mudaeraldi

Suurus	d1	L	H	L1	P
1/4"	1	65	43	14	2,5
3/8"	1	65	43	14	2,5
1/2"	1	65	43	14	2,5
3/4"	1	75	53	19	2,5
1"	1,5	90	60	23	3
1-1/4"	1,5	110	72	27,5	3
1-1/2"	2	120	90	32,5	4
2"	2	150	110	40	4

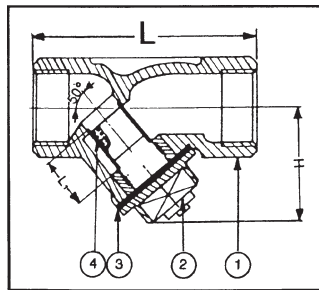

Tagasilöögiventil

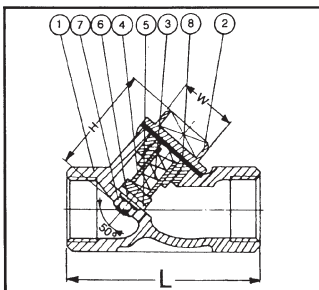

Suurus	L	H	W
1/4"	65	40	27
3/8"	65	40	27
1/2"	65	40	27
3/4"	75	50	34
1"	90	62	40
1-1/4"	110	70	50
1-1/2"	120	85	57
2"	150	100	89

Täisauk 3-osaline AISI 316 S/S (sise/sise), keevitatav

Suurus	d	L	H	W
1/4"	11,6	65	42	98
3/8"	12,7	65	42	98
1/2"	15	66	49	115
3/4"	20	83	52	115
1"	26,4	95	62	143
1-1/4"	32	111	66	143
1-1/2"	38	130	77	178
2"	50,8	151	85	178
2-1/2"	65	185	139	250
3"	80	212	150	250
4"	100	270	173	280

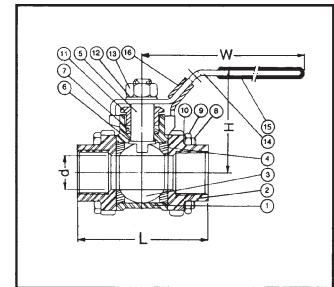

Nõelventil NP 400

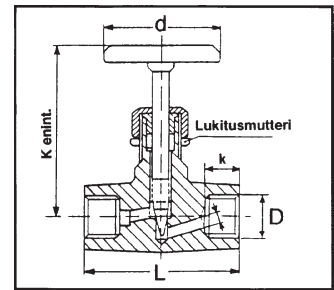

Rõhk	400	160	125	100
Temperatuur +°C	20	125	200	280

Suurus		k	D	L	d	Kõrgus K	Kaal kg
mm	"						
8	1/4"	14	5	60	65	85	0,40
10	3/8"	15	5	60	65	85	0,38
15	1/2"	16	5	60	65	85	0,34
20	3/4"	18	8	70	75	100	0,90
25	1"	20	10	78	85	110	1,05

TOIDUAINETETÖÖSTUSETORUDJATARVIKUD

SMS-standard

Torud

AISI 304 ja 316 L

Du	19	25	32	38	51	63,5	76,1	101,6
s	1,25	1,25	1,25	1,25	1,25	1,5	2	2

Keevitatavad tarvikud

Põlv1D90°,100-2 AISI 304 ja 316 L

D	25	32	38	51	63,5	76,1	101,6
s	1,25	1,25	1,25	1,25	1,5	2	2
R1	25	32	38	51	63	76	110
EA	55	65	70	82	105	110	150
PD	30	33	32	24	41	34	42

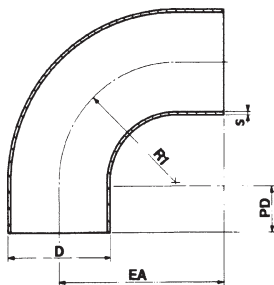

Põlv1,5D90°,100-2 AISI 304 ja 316 L

D	19	25	38	51	63,5	76,1	101,6
s	1,5	1,5	1,5	1,5	1,5	2	2
R	29	38	56	72	84	85	110

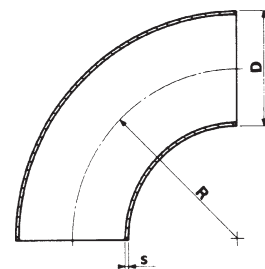

Põlv45°,101-0 AISI 304 ja 316 L

D	25	32	38	51	63,5	76,1	101,6
s	1,25	1,25	1,25	1,25	1,5	2	2
R	37	44	38	51	90	95	110
PD	28	28	30	30	35	35	35

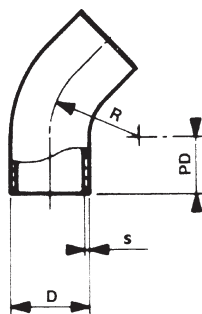

Kaar3D90°,102-0 AISI 304 ja 316 L

D	25	38	51	63,5	76,1
s	1,5	1,5	1,5	1,5	2
R	75	115	150	180	215
PD	40	56	30	50	50
EA	115	140	225	240	250

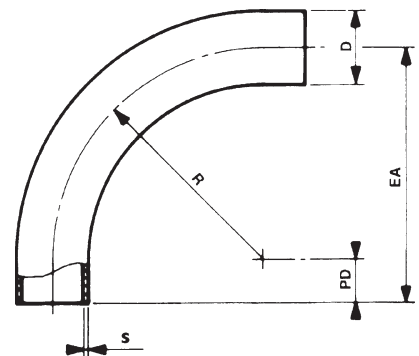

Kolmik, 105-0 AISI 304 ja 316 L

D	25	38	51	63,5	76,1	101,6
s	1,5	1,5	1,5	1,5	2	2
A	55	70	82	105	110	150

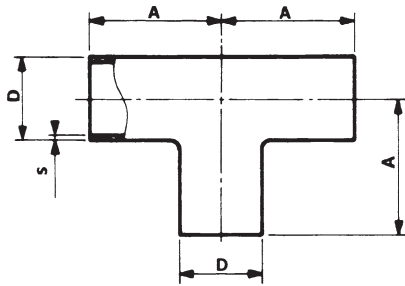
**Kolmik, 106-0 AISI 304 ja 316 L**

D	25	32	38	51	63,5	76,1	101,6
s	1,5	1,5	1,5	1,5	1,5	2	2
A	55	66	70	82	105	110	150
B	19	23	30	35	45	45	60

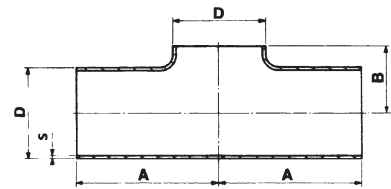
**Üleminekuga kolmik, 106-0 AISI 304 ja 316 L**

D	38	51	63,5	76,1	101,6										
d	25	25	38	25	38	51	25	38	51	63,5	25	38	51	63,5	76,1
s	1,5	1,5	1,5	1,5	1,5	1,5	2	2	2	2	2	2	2	2	2
A	70	82	82	105	105	105	110	110	110	110	150	150	150	150	150
c	28	35	35	43	43	43	43	43	34	43	60	60	60	60	60

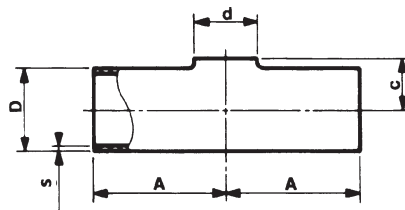
**Rist, 107-0 AISI 304 ja 316 L**

D	25	38	51	63,5	76,1	101,6
s	1,5	1,5	1,5	1,5	2	2
A	55	70	82	105	110	150

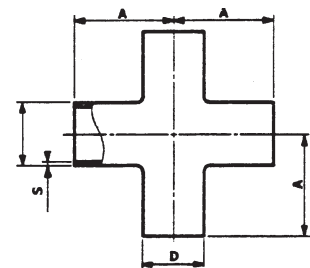
**ÜleminekKT, 111-0 AISI 304 ja 316 L**

D	38	51	63,5	76,1	101,6				
d	25	25	38	38	51	38	51	63,5	76
s	1,5	1,5	1,5	1,5	1,5	2	2	2	2
G	40	80	40	80	37	117	76	38	85

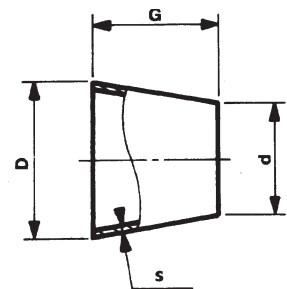
**Üleminek ET, 111-0 AISI 304 ja 316 L**

D	38	51	63,5	76,1	101,6				
a	25	25	38	38	51	38	51	63,5	76,1
s	1,5	1,5	1,5	1,5	1,5	2	2	2	2
L	44	86	44	84	40	125	81	41	81

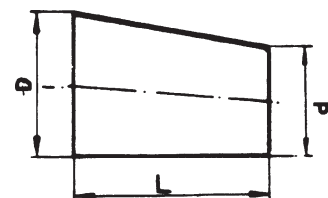

Clamp-ühendused

Clamp-klamber, 10 bar 120° C, 114-0 AISI 304

D	10-19	12-22	25-38	51	63,5	76,1	101,6
G	39	46	65,2	78,7	92,2	105,7	133,7
F			53,9	67,4	80,8	94,4	122,4

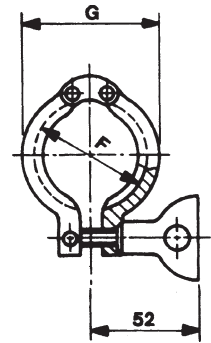

Clamp-rõngas, keevitatav, 115-0 AISI 316L

D	10-22	25	38	51	63,5	76,1	101,6
A	25-34	50,5	50,5	64	77,5	91	118
H	20	x	x	x	x	x	x

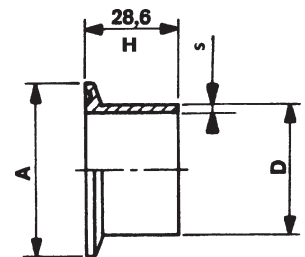

Camp-tihend EPDM ja VITON, 116-0

D	10-22	25	38	51	63	76,1	101,6
A	25-34	53,5	53,5	67	80,5	94	122

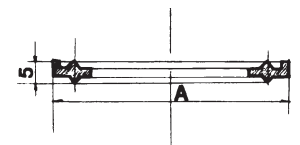

Clamp-pimeseib, 117-0 AISI 316L

D	10-19	12-22	25-38	51	63	76,1	101,6
A	25	34	50,5	64	77,5	91	118
E		5	6,3	6,3	6,3	6,3	7,9

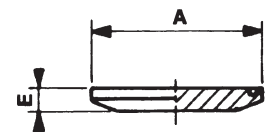

Ühenduse osad

Ühenduse mutter, 121-1 AISI 304 ja AISI 316L

DN	25	38	51	63,5	76,1	101,6
A	51	74	84	100	114	154
B	40x1/6	60x1/6	70x1/6	85x1/6	98x1/6	132x1/6
E	20	25	26	30	30	32

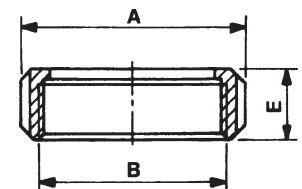

Ühenduse keere, keevitatav, 122-0 AISI 304 ja 316 L

DN	25	38	51	63,5	76,1	101,6
B	40x1/6	60x1/6	70x1/6	85x1/6	98x1/6	132x1/6
C	22,5	35,5	48,5	60,5	72	97,6
D	25,6	38,6	51,6	64,1	76,6	102,1
G	20	23	25	30	35	30

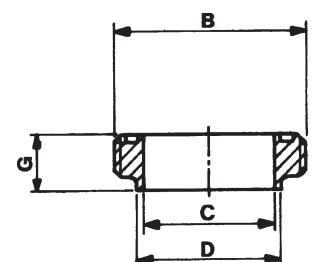

Ühenduse keere, 122-1 AISI 304

DN	25	38	51	63,5	76,1	101,6
B	40x1/6	60x1/6	70x1/6	85x1/6	98x1/6	-
C	25,1	38,1	51,1	63,6	76,2	-
D	20	23	25	30	35	-

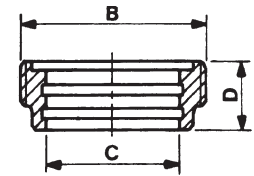

Ühenduse keere, keevitatav, 123-0 AISI 304 ja 316 L

DN	25	38	51	63,5	76,1	101,6
A	22,5	35,5	48,5	60,5	72	97,6
C	25,6	38,6	51,6	64,1	76,6	102,1
D	32	48	60	73	86	116
F	35,5	55	65	80	93	127
G	17	20	20	24	30	32

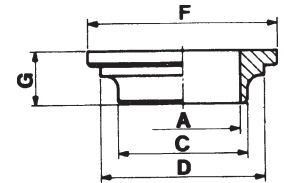

Ühenduse rõngas, 123-1 AISI 304

DN	25	38	51	63,5	76,1	101,6
C	25,1	38,1	51,1	63,6	76,2	-
F	35,5	55	65	80	93	-
G	17	20	24	25	30	-

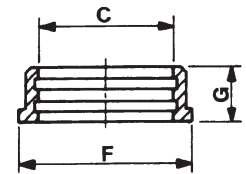

Ühenduse tihend EPDM, VITON, TEFLON, 124-1

DN	25	38	51	63,5	76,1	101,6
C	22,5	35,5	48,5	50,5	72	98
O	32	48	60	73	86	114

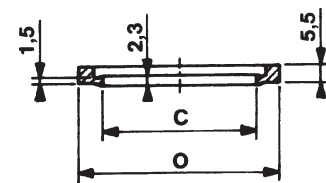

Kork ketiga, 125-1 AISI 304 ja NYLON

DN	25	38	51	63,5	76,1	101,6
A	51	74	84	100	114	154
B	40x1/6	60x1/6	70x1/6	85x1/6	98x1/6	132x1/6
E	20	25	26	30	30	30
H	28	33	34	38	38	38

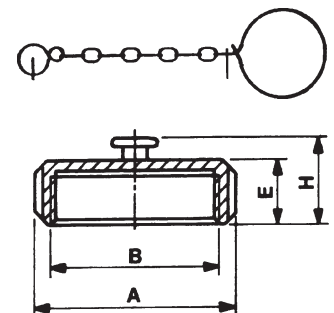

Korgi seib, 126-1 AISI 304 ja 316 L

DN	25	38	51	63,5	76,1	101,6
F	35,5	55	65	80	93	127
J	31,7	48,7	60	72,4	86	116
K	7	8	9	9	10	11

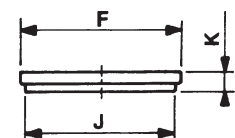

Voolikuühenduse rõngas, 130-1 AISI 304

DN B	25	38	51	63,5	76,1	101,6
A	90	90	90	90	90	90
C	35,5	55	65	80	93	127

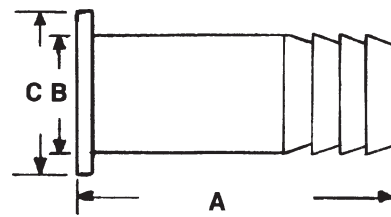

Voolikuühenduse hülss, 130-2 AISI 304 ja 316 L

D N D	25	38	51	63,5	76,1	101,6
s	1,25	1,25	1,25	1,5	2	2

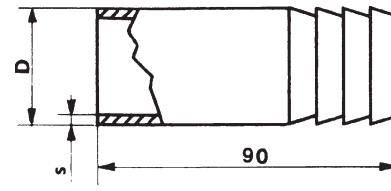

Ventiili ühendus, 131-1 AISI 304

DN	25	38	51	63,5	76,1	101,6
A	50	60	60	70	70	80
B	40x1/6	60x1/6	70x1/6	89x1/6	98x1/6	125x1/4
C	R 1"	R 1 1/2"	R 2"	R 2 1/2"	R 3"	R 4"

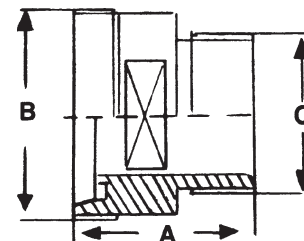

Ventiilid

Liblikventiil, keevitatav, 150-0 AISI 316 L

DN	25	38	51	63,5	76,1	101,6
B	34	38	40	40	41	44
d	22	35	48	60,5	72	97
L	61	65	74	78	85	102

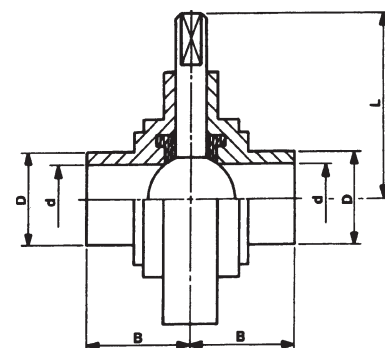

Liblikventiil, keermestatud, 150-1 AISI 316 L

DN	25	38	51	63,5	76,1	101,6
A	34	38	40	40	41	41
d	23	36	48	61	72	98
E	40	60	70	85	98	132
L	61	65	74	78	85	102

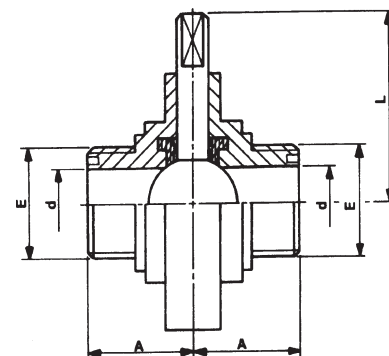

Liblikventiili tihend S ILICON, VITON, EPDM

DN	25	38	51	63,5	76,1	101,6
D	23	23	23	23	25	29
K	44	51,5	65,5	76,5	89	121
L	27	34,5	48,5	59,5	70	99
M	10,8	10,8	10,8	10,8	10,8	14,7

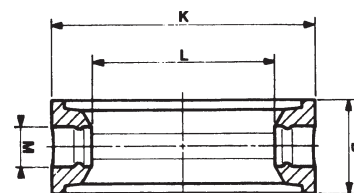

Tagasilöögi ventiil, keermestatud, 155-1 AISI 304 ja 316 L

DN/A	25	38	51	63,5	76,1	101,6
B	60	62	72	82	92	136
c	51	73	83	98	114	155

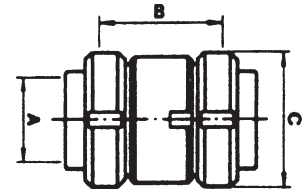
**2T ventiil, keevitav, 170-0 AISI 304 ja 316 L**

DN/d	25	38	51	63,5	76,1	101,6
h	50	60	70	80	90	120
H	130	160	180	200	220	300
L	110	140	165	210	220	300

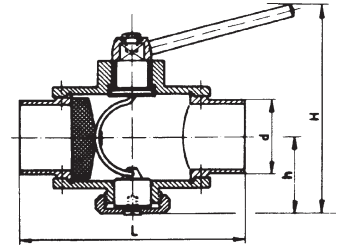
**2T ventiil, keermestatud, 170-1 AISI 304 ja 316 L**

DN/d	25	38	51	63,5	76,1	101,6
h	50	60	70	80	90	120
H	130	160	180	200	220	300
L	110	140	165	210	220	300

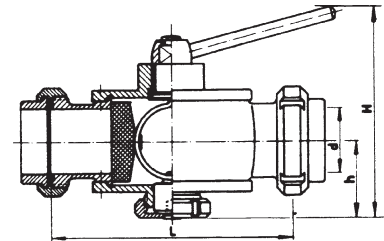
**3T ventiil, keevitav, 171-0 AISI 304 ja 316 L**

DN/d	25	38	51	63,5	76,1	101,6
h	50	60	70	80	90	120
H	130	160	180	200	220	300
L	110	140	165	210	220	300

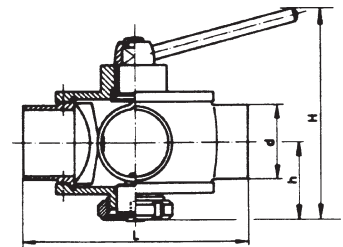
**3T ventiil, keermestatud, 171-1 AISI 304 ja 316 L**

DN/d	25	38	51	63,5	76,1
h	50	60	70	80	90
H	130	160	180	200	220
L	110	140	165	210	220

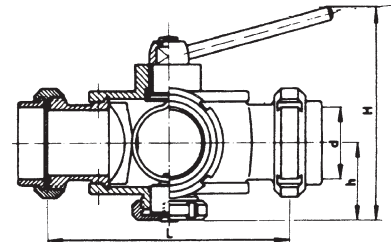
**Muut osad****Vaateklaas, keermestatud, 157-1 AISI 304 ja 316 L**

DN/D	25	38	51	63,5	76,1	101,6
L	165	165	165	165	165	165
C	40-6	60-6	70-6	85-6	98-6	132-6

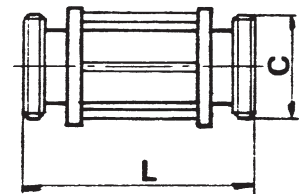
**Toruõlter, keevitav, 165-0 AISI 304 ja 316 L**

DN/D	25	38	51	63,5	76,5
B	275	275	275	315	315
L	310	310	310	350	350

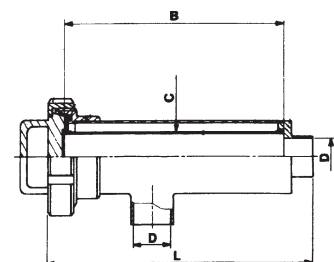

Proovikraan 90°, 173 AISI 316 L

A	R 1/4"
C	60

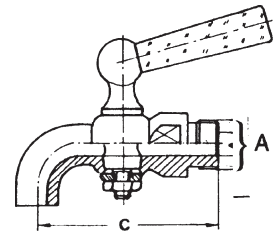
**Proovikraan, 180°, 173 S AISI 316 L**

A	R 1/4"
C	70

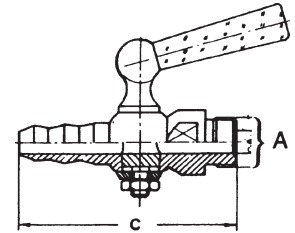
**Toru vahelüli, keevitatav, 174-0 AISI 304**

DN/A	25	38	51	63,5	76,1	101,6
B	110	110	110	110	110	110

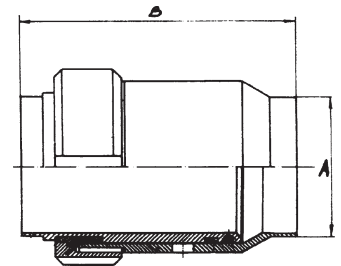
**Pesupall, 175-0 AISI 316 L**

	28x50	28x65	38x65	38x90
D	50	65	65	90
K	22	28	38	38
M	20	26	36	36
L	74	92	90	121
P	26	30	32	39
Avad Ø mm	1,6	2,5	2,5	2,5
Pesu ulatus m	1,2	1,6	1,6	2
Vee hulk m³/h	3,6	9	9,6	13

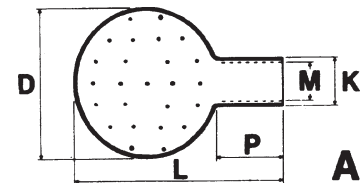
**Torukandja, 181 AISI 304**

Ø	25	38	51	63,5	76,1	101,6
---	----	----	----	------	------	-------

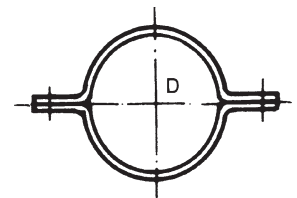
**Torukandja, toel, 182 AISI 304**

Ø	25	38	51	63,5	76,1	101,6
---	----	----	----	------	------	-------

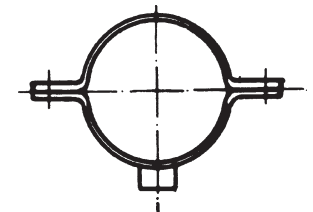

Torukandja, plastikisolatsiooniga, 183 T

Ø	25	38	51	63,5	76,1	101,6
---	----	----	----	------	------	-------

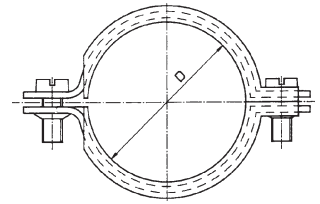
**Põrandataldrik, 207 AISI 304**

A	25	38	51	63,5	76,1
B	73	80	88	92	150
C	120	120	120	120	200

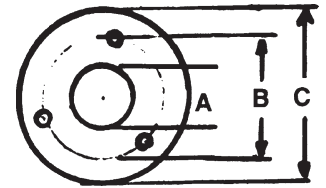
**Ühenduse võti, 25-101,6,209 AISI 304**

A	315
---	-----

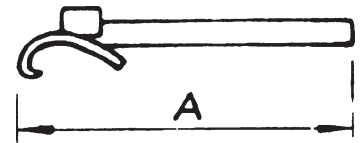
**Kett, 215 AISI 316**

	2	3
B	12	19
C	4	6

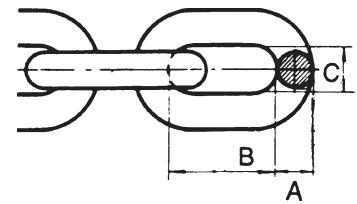
**Saetugi**

25	38	51	63,5	76,1	101,6
----	----	----	------	------	-------

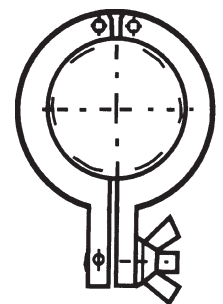

DIN-standard

Toru, AISI 304 ja 316 L

Du	12	18	22	28	34	40	52	70	85	104
s	1	1	1	1	1	1	1	2	2	2

Pölv 1,5 D 90°, 100-1 AISI 304 ja 316 L

D	18	22	28	34	40	52	70	85	104
s	1,5	1,5	1,5	1,5	1,5	1,5	2	2	2
R	35	40	43	52	60	72	85	93	110

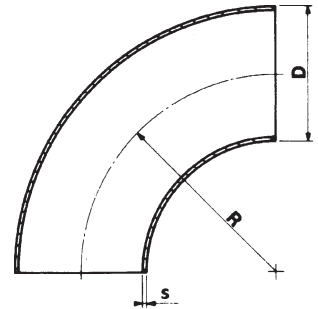

Kolmik, 106-2 AISI 304 ja 316 L

D	18	22	28	34	40	52	70	85	104
s	1,5	1,5	1,5	1,5	1,5	1,5	2	2	2
A	43	45	50	56	67	72	85	98	150

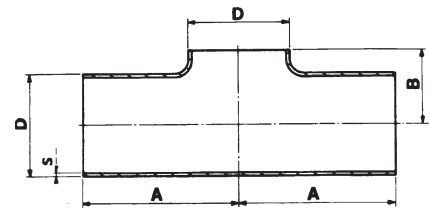

Rist, 107-2 AISI 304 ja 316 L

D	18	22	28	34	40	52	70	85	104
s	1,5	1,5	1,5	1,5	1,5	1,5	2	2	2
A	43	45	50	56	67	72	85	98	150

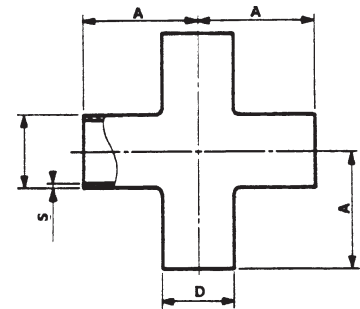

Üleminek, 110-2 AISI 304 ja 316 L

D	22	28	34	40	52	70	85	104				
d	18	22	28	28	34	34	40	40	52	70	70	85
s	1,5	1,5	1,5	1,5	1,5	1,5	1,5	2	2	2	2	2
L	60	60	80	102	88	129	113	120	130	120	127	120

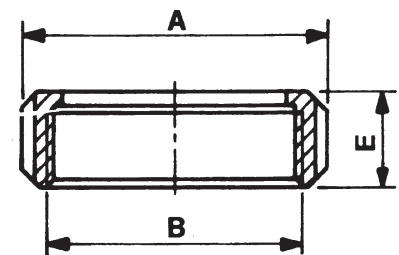
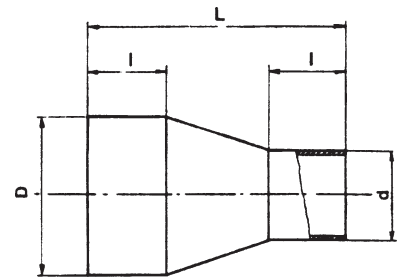

Ühenduse mutter, 121-2 AISI 304

NW	10/12	15/18	20/22	25/28	32/34	40/40	50/52	65/70	80/85	100/104
A	38	44	54	63	70	78	92	112	127	148
B	28x1/8	34x1/8	44x1/6	52x1/6	58x1/6	65x1/6	78x1/6	95x1/6	110x1/4	130x1/4
E	25	32	38	51	63	76	x	x	x	x

Ühenduse rõngas, keevitatav, 123-2 AISI 304 ja 316 L

NW	10	15	20	25	32	40	50	65	80	100
DN	12	18	22	28	34	40	52	70	85	105
A	10	15	20	26	32	38	50	66	81	100
D	22	28	36	44	50	56	68	86	100	121
E	17	17	18	22	25	26	28	32	37	44

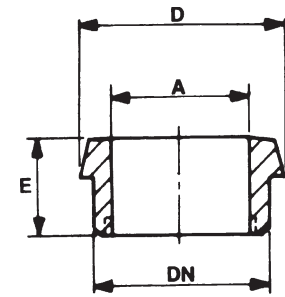

Ühenduse tihend, EPDM, VITON, 124-2

NW	10	15	20	25	32	40	50	65	80	100
d1	20	28	33	40	46	52	64	81	95	114
d2	12	18	23	30	36	42	54	71	85	104
s	4	5	5	5	5	5	5	5	5	6

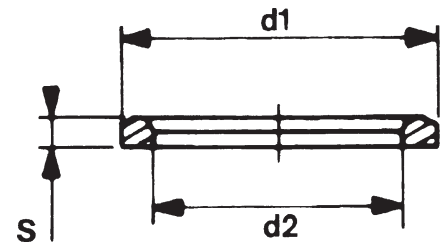

Ühenduse keere, keevitatav, 122-2 AISI 304 ja 316 L

NW	10	15	20	25	32	40	50	65	80	100
DN	12	18	22	28	34	40	52	70	85	104
A	10	16	20	26	32	38	50	66	81	100
B	28x1/8	34x1/8	44x1/6	52x1/6	58x1/6	65x1/6	78x1/6	95x1/6	110x1/4	130x1/4
C	21	21	22	29	32	33	35	40	45	54

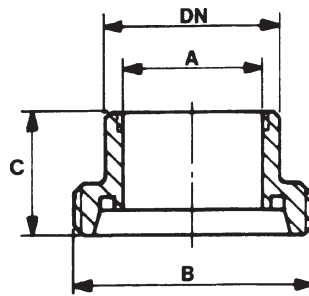

Liblikventiil, keevitatav, 150-2-0 AISI 316 L

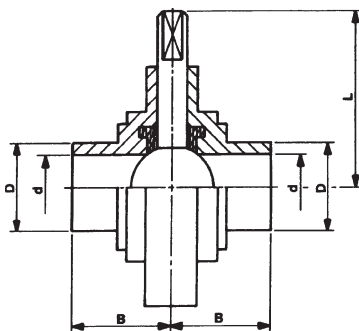

NW	25	32	40	50	65	80	100
B	34	38	38	40	41	42	44
D	28	34	42	65	70	85	104
L	61	65	65	75	85	90	102

Liblikventiil, keermestatud, 150-2-1 AISI 316 L

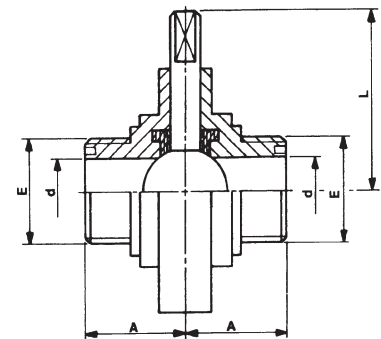

NW	25	32	40	50	65	80	100
A	34	34	38	38	38	42	44
d	25	31	37	49	66	81	100
E	52	58	65	78	95	110	130
L	61	65	65	75	85	90	102

Liblikventiili tihend, 150 SILICON, VITON, EPDM

NW	25	32	40	50	65	80	100
D	23,2	23,2	23,2	23,2	25,4	25,4	25,4
K	43,6	52,3	55,6	66	89	99	119
L	27	35	39	49	70	80	100
M	10,8	10,8	10,8	10,8	10,8	14,7	14,7

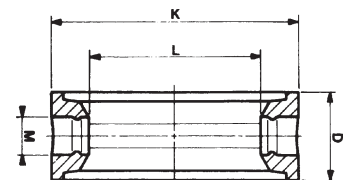

Nelikanttorud

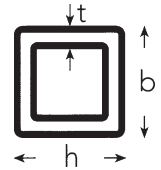

h mm	b mm	t mm	A mm ²	m kg/m
25	25	1,20	111	0,925
25	25	1,50	135	1,146
25	25	2,00	174	1,495
25	25	3,00	241	2,216
30	30	1,20	135	1,106
30	30	1,50	165	1,371
30	30	2,00	214	1,840
30	30	3,00	301	2,720
32	32	1,20	144	1,190
32	32	1,50	177	1,470
34	34	1,20	154	1,210
34	34	1,50	189	1,490
35	35	1,20	159	1,310
35	35	1,50	195	1,620
35	35	2,00	254	2,150
35	35	3,00	361	3,152
38	38	1,20	173	1,415
38	38	1,50	213	1,758
38	38	2,00	278	2,319
40	40	1,20	183	1,496
40	40	1,50	225	1,859
40	40	2,00	294	2,454
40	40	3,00	421	3,756
40	40	4,00	535	4,808
50	50	1,50	285	2,329
50	50	2,00	374	3,080
50	50	3,00	541	4,650
50	50	4,00	695	5,960
50	50	5,00	836	7,410
50	50	6,00	963	8,832
60	60	1,50	345	2,802
60	60	2,00	454	3,711
60	60	3,00	661	5,491
60	60	4,00	855	7,222
60	60	5,00	1036	8,902
70	70	2,00	534	4,380
70	70	3,00	781	6,530
70	70	4,00	1015	8,450
70	70	5,00	1236	10,629
80	80	2,00	614	4,988
80	80	3,00	901	7,530
80	80	4,00	1175	9,816

h mm	b mm	t mm	A mm ²	kg/m
80	80	5,00	1436	12,395
80	80	6,00	1683	14,600
100	100	2,00	774	6,400
100	100	3,00	1141	9,530
100	100	4,00	1495	12,400
100	100	5,00	1836	15,380
100	100	6,00	2163	17,500
100	100	8,00	2724	21,600
100	100	10,00	3257	25,800
120	120	3,00	1381	11,300
120	120	4,00	1815	15,030
120	120	5,00	2236	18,660
120	120	6,00	2643	21,200
120	120	8,00	3364	26,580
120	120	10,00	4057	32,370
150	150	3,00	1741	14,064
150	150	4,00	2295	18,624
150	150	5,00	2836	22,400
150	150	6,00	3363	27,360
150	150	8,00	4324	34,300
150	150	10,00	5257	41,650
150	150	12,50	6338	50,570
200	200	4,00	3095	24,600
200	200	5,00	3814	30,800
200	200	6,00	4532	36,900
200	200	8,00	5924	47,250
200	200	10,00	7257	57,600
200	200	12,50	8838	69,830
220	220	6,00	5012	39,600
220	220	8,00	6564	51,900
220	220	10,00	8057	63,650
220	220	12,50	9838	77,730
250	250	5,00	4836	38,400
250	250	6,00	5732	45,700
250	250	8,00	7524	59,450
250	250	10,00	9257	73,500
250	250	12,50	11338	89,600
300	300	5,00	5836	46,200
300	300	6,00	6932	55,300
300	300	8,00	9124	72,800
300	300	10,00	11257	89,800
300	300	12,50	13838	109,350

h mm	b mm	t mm	A mm ²	m kg/m
30	20	1,20	111	0,925
30	20	1,50	135	1,146
30	20	2,00	174	1,495
40	10	1,50	135	1,146
40	10	2,00	174	1,495
40	20	1,20	135	1,106
40	20	1,50	165	1,371
40	20	2,00	214	1,840
40	30	1,20	159	1,310
40	30	1,50	195	1,620
40	30	2,00	254	2,150
40	30	3,00	361	3,152
50	10	1,50	165	1,371
50	10	2,00	214	1,840
50	20	1,20	159	1,310
50	20	1,50	195	1,620
50	20	2,00	254	2,150
50	25	1,20	171	1,415
50	25	1,50	210	1,758
50	25	2,00	274	2,319
50	25	3,00	391	3,456
50	30	1,20	183	1,496
50	30	1,50	225	1,859
50	30	2,00	294	2,454
50	30	3,00	421	3,756
50	30	4,00	535	4,808
50	40	1,50	255	2,122
50	40	2,00	334	2,804
50	40	3,00	481	4,131
60	10	1,50	195	1,620
60	10	2,00	254	2,150
60	20	1,20	183	1,496
60	20	1,50	225	1,859
60	20	2,00	294	2,454
60	30	1,50	255	2,122
60	30	2,00	334	2,804
60	30	3,00	481	4,131
60	30	4,00	615	4,650
60	40	1,50	285	2,329
60	40	2,00	374	3,080
60	40	3,00	541	4,650
60	40	4,00	695	5,960
70	20	2,00	334	2,804
70	40	2,00	414	3,405
70	40	3,00	601	5,070
70	50	2,00	454	3,711
70	50	3,00	661	5,491
80	10	1,50	255	2,122
80	10	2,00	334	2,804
80	20	1,50	285	2,329
80	20	2,00	374	3,080
80	40	1,50	345	2,802
80	40	2,00	454	3,711
80	40	3,00	661	5,491
80	40	4,00	855	7,222
80	40	5,00	1036	8,902
80	50	1,50	375	2,964
80	50	2,00	494	4,060
80	50	3,00	721	5,928
80	50	4,00	935	7,808
80	50	5,00	1136	9,469
80	60	2,00	534	4,380
80	60	3,00	781	6,530
80	60	4,00	1015	8,450
80	60	5,00	1236	10,629
100	40	2,00	534	4,380
100	40	3,00	781	6,530

h mm	b mm	t mm	A mm ²	m kg/m
100	40	4,00	1015	8,450
100	40	5,00	1236	10,629
100	50	2,00	574	4,680
100	50	3,00	841	6,950
100	50	4,00	1095	9,090
100	50	5,00	1336	11,240
100	50	6,00	1563	13,490
100	60	2,00	614	4,988
100	60	3,00	901	7,530
100	60	4,00	1175	9,816
100	60	5,00	1436	12,395
100	60	6,00	1683	14,600
100	80	2,00	694	5,624
100	80	3,00	1021	8,388
100	80	4,00	1335	11,050
100	80	5,00	1636	13,750
100	80	6,00	1923	16,220
120	40	2,00	614	4,988
120	40	3,00	901	7,530
120	40	4,00	1175	9,816
120	40	5,00	1436	12,395
120	60	2,00	694	5,624
120	60	3,00	1021	8,388
120	60	4,00	1335	11,050
120	60	5,00	1636	13,750
120	60	6,00	1923	16,220
120	80	2,00	774	6,400
120	80	3,00	1141	9,530
120	80	4,00	1495	12,400
120	80	5,00	1836	15,380
120	80	6,00	2163	17,500
150	50	3,00	1141	9,530
150	50	4,00	1495	12,400
150	50	5,00	1836	15,380
150	100	3,00	1441	11,664
150	100	4,00	1895	15,424
150	100	5,00	2336	18,800
150	100	6,00	2763	22,560
150	100	8,00	3524	27,900
150	100	10,00	4257	33,650
160	80	3,00	1381	11,300
160	80	4,00	1815	15,030
160	80	5,00	2236	18,660
160	80	6,00	2643	21,200
200	100	3,00	1741	14,064
200	100	4,00	2295	18,624
200	100	5,00	2836	22,400
200	100	6,00	3363	27,360
200	100	8,00	4324	34,300
200	100	10,00	5257	41,650
250	150	5,00	3814	30,800
250	150	6,00	4532	36,900
250	150	8,00	5924	47,250
250	150	10,00	7257	57,600
250	150	12,50	8838	69,850
300	100	5,00	3814	30,800
300	100	6,00	4532	36,900
300	100	8,00	5924	47,250
300	100	10,00	7257	57,600
300	200	6,00	5732	45,700
300	200	8,00	7524	59,450
300	200	10,00	9257	73,500
300	200	12,50	11338	89,600
400	200	6,00	6932	55,300
400	200	8,00	9124	72,800
400	200	10,00	11257	89,800
400	200	12,50	13838	109,350

Roostevabad ja happeskindlad kangterased

Latt

DIN 1017 lõõmutatud ja peitsitud

Mõõt mm	Kaal kg/m
20x 3	0,48
20x 4	0,64
20x 5	0,80
20x 6	0,94
20x 8	1,26
20x10	1,58
20x12	1,88
25x 3	0,60
25x 4	0,80
25x 5	1,00
25x 6	1,20
25x 8	1,60
25x10	2,00
25x12	2,35
25x15	3,00
30x 3	0,72
30x 4	0,96
30x 5	1,20
30x 6	1,45
30x 8	1,92
30x10	2,40
30x12	2,90
30x15	3,60
30x20	4,70
30x25	5,89
35x 6	1,65
35x10	2,75
35x20	5,50
40x 4	1,26
40x 5	1,57
40x 6	1,88
40x 8	2,51
40x10	3,20
40x12	3,90
40x15	4,80
40x20	6,40
40x25	7,85
40x30	9,42
45x20	7,07
45x30	10,60
45x35	12,36
50x 5	2,00
50x 6	2,40
50x 8	3,20
50x10	4,00
50x12	4,80
50x15	6,00
50x20	8,00
50x25	10,00

Mõõt mm	Kaal kg/m
50x30	11,78
50x40	15,70
60x 5	2,36
60x 6	2,90
60x 8	3,90
60x10	4,80
60x12	5,80
60x15	7,20
60x20	9,60
60x25	11,70
60x30	14,40
60x40	16,50
60x50	23,56
70x 6	3,30
70x 8	4,50
70x10	5,60
70x12	6,59
70x15	8,24
70x20	10,99
70x25	13,74
70x30	16,50
80x 5	3,15
80x 6	3,90
80x 8	5,10
80x10	6,40
80x12	7,70
80x15	12,00
80x20	12,80
80x25	15,70
80x30	18,84
80x40	25,10
100x6	4,80
100x8	6,40
100x10	8,00
100x12	9,60
100x15	12,00
100x20	16,00
100x25	20,00
100x30	23,50
120x10	9,60
120x12	11,30
120x15	14,13
120x20	18,90
120x25	20,55
150x10	11,80
150x12	14,10
150x15	17,70
150x20	23,55
150x25	29,44

Nurk

DIN 1028 lõõmutatud ja peitsitud

Mõõt mm	Kaal kg/m
20x 20x 3	0,9
25x 25x 3	1,2
30x 30x 3	1,4
30x 30x 4	1,8
40x 40x 4	2,5
40x 40x 5	3,0
50x 50x 5	3,8
60x 60x 6	5,5
70x 70x 7	7,5
80x 80x 8	9,8
100x100x100	15,2

Nelikantteras

DIN 178 venitatud tol. H11

Mõõt mm	Kaal kg/m
10x10	0,80
15x15	1,76
20x20	3,20
25x25	5,00
30x30	7,20
35x35	9,60
40x40	12,90
45x45	15,90
50x50	15,40
60x60	28,26

Ümar DIN 668 lihvitud tol. H9 venitatud tol. H 11

Mõõt mm	Kaal kg/m
6	0,23
8	0,40
10	0,63
12	0,90
13	1,00
14	1,24
15	1,38
16	1,57
18	2,04
20	2,50
22	3,00
24	3,68
25	3,87
28	4,90
30	5,55
32	6,30
35	7,55
40	9,86
45	12,50
50	15,41
55	18,65
60	22,20
65	26,05
70	30,21

Kuuskantteras

DIN 176 venitatud tol. H11

Mõõt mm	Kaal kg/m
14	1,4
17	2,0
19	2,5
22	3,3
24	4,0
27	5,0
30	6,2
32	7,0
36	9,0
41	11,5
46	14,5
50	17,0

Roostevabad- ja happekindlad lehed

Paksus alates 0,5 mm kuni ...

Suurus alates 1,0 x 2,0 m kuni ...

Käsitugede ja piirete tarvikud

KO-2060
Piirdetoru 40x1,5 mm
Pikkus 6 m, lihvitud GRIT 320

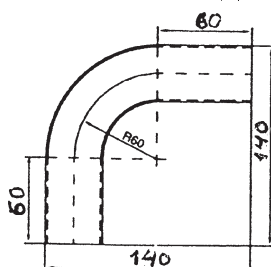

KO-2061
90° nurga liitmik

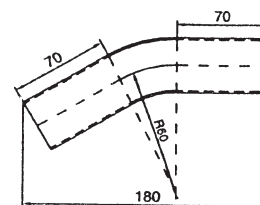

KO-2062
30° nurga liitmik. Sobib trepi ja tasapinna ühendamiseks.

KO-2064
Pikemad piirded ühendatakse liitmike abil

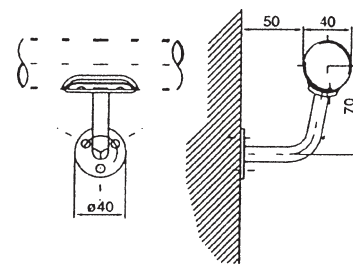
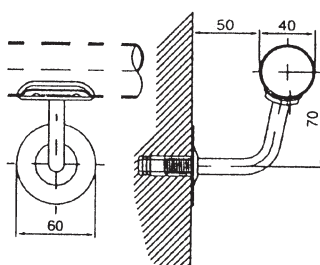
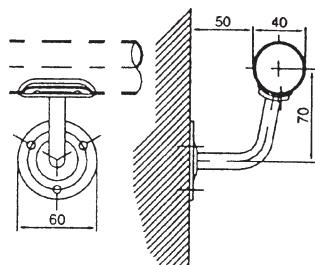

KO-2068
Kruvikinnitusega seinatugi on mõeldud puuseintele ja teraskonstruktsioonidele. Soovitatav kinnituste vahe on 1,3 m.

KO-2069
Kiilankrutega M12 kinnitavavad seinatöed on mõeldud betoonseintele. Soovitatav kinnituste vahe on 1,2 m.

KO-2072
Kruvikinnitusega seinatugi on mõeldud normaalsest kitsamates tingimustes puuseintele ja teraskonstruktsioonidele. Soovitatav kinnituste vahe on 1,2 m.

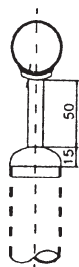

KO-2073
Ülemine kinnitus püsttoe ja käsitoe vahele. Soovitatav kinnituste vahe on 1,2 m.

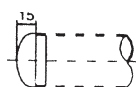

KO-2067
Lõppkork on poolkera kujuline. Kork kinnitatakse nii nagu ühendusliitmikud.

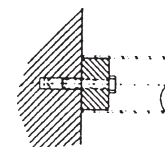

KO-2066
Lõppkinnitus kinnitatakse vastavalt seina materjalile.

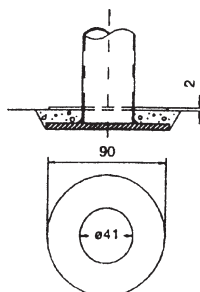

KO-2075
Püsttoe alaosas plaat betoonile.

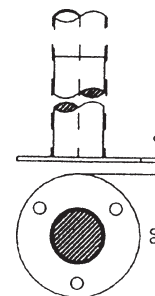

KO-2074
Püsttoe alaosas kinnitus põrandale kinnitamiseks.